

CERTIFIED LAND CORNER RECORDATION

DESCRIPTION OF CORNER EVIDENCE FOUND, AND ORIGINAL RECORD (IF KNOWN)

Searched for, but found no evidence of original monument. Found 1/2" dia. axle in old fence corner post hole.

See plat filed as H-1495 Lake County Records for further details.

DESCRIPTION OF MONUMENT AND ACCESSORIES ESTABLISHED TO PERPETUATE THE ORIGINAL LOCATION OF THIS CORNER:

Date of work: June, 1969

Accepted axle as best evidence of corner.

N
Azimuths are 0° declination. All trees are scribed R.M.

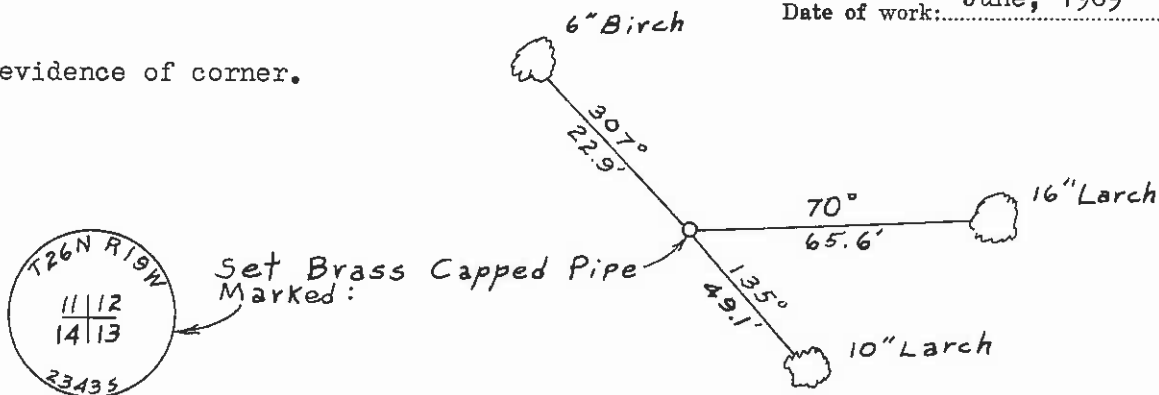

SKETCH, WITH COURSE AND DISTANCE TO ADJACENT CORNERS IF DETERMINED IN THIS SURVEY. (MAY SKETCH OR PASTE REPRODUCTION ON REVERSE SIDE.)

Surveyor's Seal



I, _____
certify that the information shown herein is true and correct.

Signature of Ground Party Chief

J.T. Shaw, RLS

I, _____
certify that I have carefully performed or reviewed the work done on the diagrammed corner as reported on this recordation form and approve the same.

J.T. Shaw
Signature of Surveyor

DIAGRAM OF CORNER:

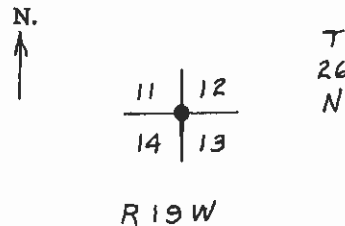

● = Corner recorded on the sheet

23435
Registration Number

Office of Clerk and Recorder, County of Lake

This "corner record" was filed for record on the 3 day of Sept 1969, was noted on the cross-index plat and is

assigned page No. C62, in book No. 1

ETHEL M. HARDING

County Official