

INSTRUCTIONS

1. Original and/or subsequent record used to evaluate the corner position.
2. Description of evidence found, note discrepancies in the record, state method of establishing lost or obliterated corners.
3. Description of monument and accessories set to perpetuate the corner position.
4. Sketch of corner, show all pertinent data which can best be shown in a sketch example, corner marking, topography (ies, position of accessories, etc.
5. Certification must be signed and sealed by Land Surveyor registered in the State of Montana.
6. Fill in Cross Index & Section Diagram at bottom of sheet.

CERTIFIED CORNER RECORDATION

Corner W. 1/4 Corner Section 15 T. 25N. R. 22W. P.M.M. LAKE County

RECORD: from G.L.O. Field Book 3208, page 29, surveyed by Charles Smith in May through June 1897.

Set a fir post, 3' long, 3" square, 24" in the ground marked "1/4 S" on west face, from which:

- a 16" tamarack bears N74°45'E 14 lks. (9.24')
- a 10" fir bears S51°W 18 lks. (11.88')

FOUND: a 5/8" rebar & cap set by Balstad, from which:

- a fallen 6' tamarack stump with scribing "BT" visible, bears N75°E 9'
- a 11" fir with overgrown chest and foot blazes, bears S25°E 23.3'
- a fallen and rotten fir bears S51°W 12'
- a 12" larch with overgrown chest and foot blazes, bears N48°W 16.1'
- a north/south and west fence intersection at the found 5/8" rebar & cap

SET: nothing set, held position of 5/8" rebar & cap set by Balstad

Used a SILVA hand compass (declination 18° E)

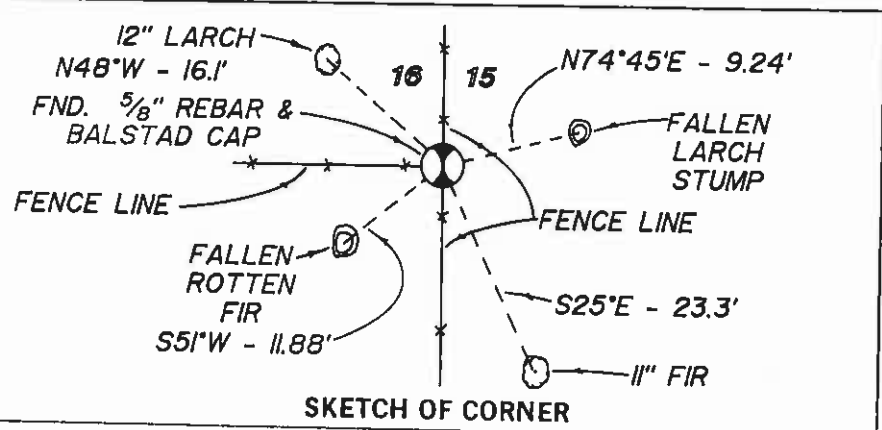
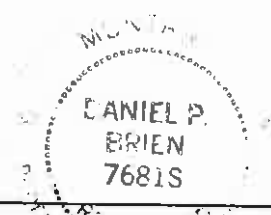

CERTIFICATION

I, DANIEL P. BRIEN, PLS, certify the information shown herein is true and correct.

Signature Ground Party Chief
DANIEL P. BRIEN, PLS

I, DANIEL P. BRIEN, PLS certify that this Corner Record correctly represents work performed by me or under my direction in compliance with the "Corner Recordation Act" (70-22-101 et seq., M.C.A.)

Signature of Surveyor & Seal
Daniel P. Brien

Date: 5/98 Reg. No. 7681S

Employer: HERSMAN LAND SURVEY

Office of Clerk and Recorder, County of LAKE. This "corner record" was filed for record on OCT 29 1998 9:34 A.M. was noted on the cross-index plat and is assigned page No. 394180, in book No. _____

by Ticki Riehn, Deputy

RUTH E. HODGES
County Official

Cross Index No. L-13 T. 25N. R. 22W. P.M.M.

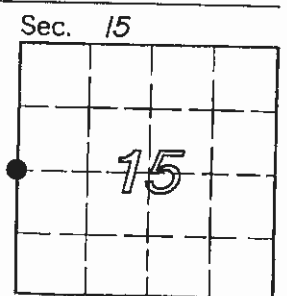

• - corner this sheet