

INSTRUCTIONS

1. Original and/or subsequent record used to evaluate the corner position.
2. Description of evidence found, note discrepancies in the record, state method of establishing lost or obliterated corners.
3. Description of monument and accessories set to perpetuate the corner position.
4. Sketch of corner, show all pertinent data which can best be shown in a sketch example, corner marking, topography ties, position of accessories, etc.
5. Certification must be signed and sealed by Land Surveyor registered in the State of Montana.
6. Fill in Cross Index & Section Diagram at bottom of sheet.

CERTIFIED CORNER RECORDATION

Corner North 1/4 Corner Sec.22 T. 24 N. R. 31 W. P.M.M. Sanders County

Found: 5/8" Rebar bent and loose.

Set: 1"x36" iron pipe & cap "WWP Co LS 5616"
in rock mound, 18' east of east edge of county road.

Reset iron pipe in position of rebar and record distance of 75.90 west of WWP Co M.C.monument, on line with WWP Co WPMC monument at a distance of 161.90.

Set yellow carsonite marker.

Bearing Trees: Set nail & tag in found BT's:

- 18" Pine S.80 E., 73.20 ft.
- 20" Fir S.30 E., 54.30

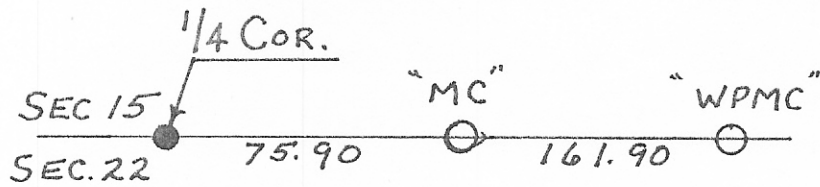
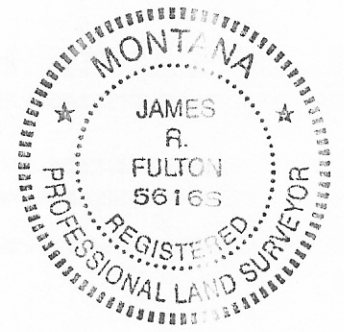

SKETCH OF CORNER

CERTIFICATION
I, James R. Fulton
certify the information shown herein is true and correct.

Signature Ground Party Chief
James R. Fulton
certify that this Corner Record correctly represents work performed by me or under my direction in compliance with the "Corner Recordation Act" (70-22-101, et seq., M.C.A.)

James R. Fulton
Signature of Surveyor & Seal
Date: 4/28/98 Reg. No. LS 5616
Employer: Washington Water Power Co.

Office of Clerk and Recorder, County of Sanders. This "corner record" was filed for record on May 14, 1998 at 10:35 am was noted on the cross-index plat and is assigned page No. _____, in book No. vol 4 pg 551 Tellie W. Blanton, By: Ronia Wright
County Official

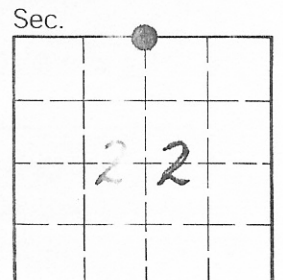

229735 N-15 T. 24N R. 31 W PMM

No Fee