

CERTIFIED LAND CORNER RECORDATION 61-255246

DESCRIPTION OF CORNER EVIDENCE FOUND, AND ORIGINAL RECORD (IF KNOWN)

FOUND: The original stone as marked in the original notes. The corner was apparently found and used for boundary control on the "Black Lake" timber sale here. There are three bearing trees remaining. The only live bearing tree is the section eight tree, which is heavily mistle toed.

ORIGINAL RECORD: Set a trap rock, 18x10x6 inches, 12 inches in the ground, for the corner of Sections 5, 6, 7 and 8 marked with 5 notches on south and east edge from which a tamarack, 24 inches dia. bears N15°45'E., 76 links dist., marked T24NR21WS5 BT. A fir, 16 ins. diam. bears S21°30'E. 70 lks distant marked T24NR21W S8 BT.

A fir, 6 ins. diam., bears S12°W., 90 links distant, marked T24N R21W S7BT.

A fir, 14 ins. diameter, bears N64°15'W., 40 links distant marked T24NR21W S6BT.

DESCRIPTION OF MONUMENT AND ACCESSORIES ESTABLISHED TO PERPETUATE THE ORIGINAL LOCATION OF THIS CORNER:

May 28 1980
June 4 80
Date of work:

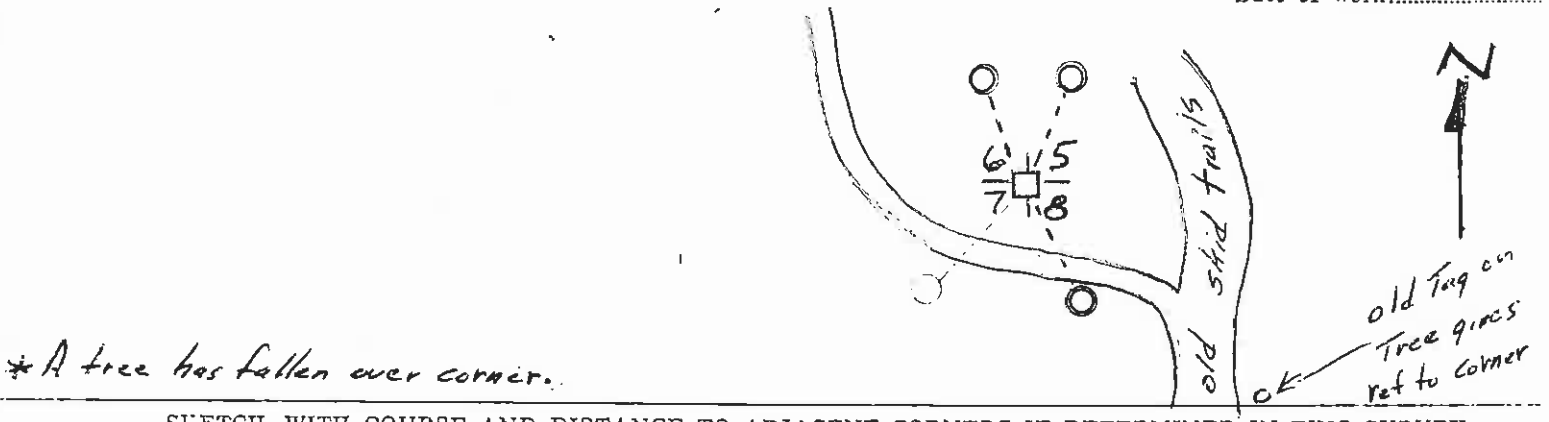

SKETCH, WITH COURSE AND DISTANCE TO ADJACENT CORNERS IF DETERMINED IN THIS SURVEY. (MAY SKETCH OR PASTE REPRODUCTION ON REVERSE SIDE.)

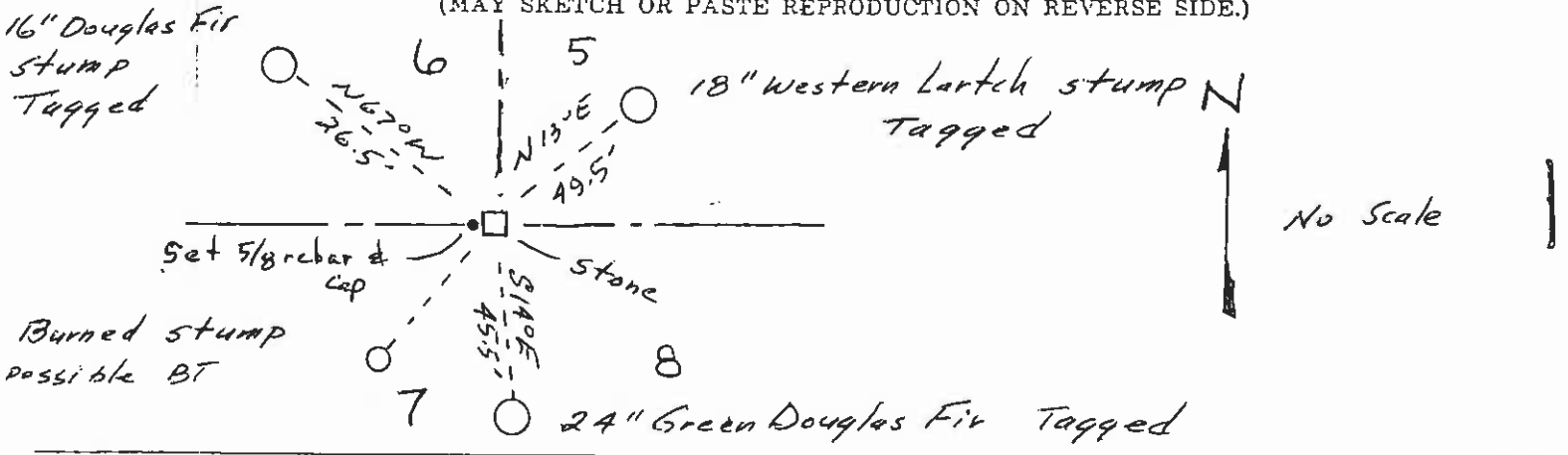

Surveyor's Seal

I, _____
certify that the information shown herein is true and correct.

Signature of Ground Party Chief

I, Christopher Balstad Jr.
certify that I have carefully performed or reviewed the work done on the diagrammed corner as reported on this recordation form and approve the same.

Christopher Balstad Jr.
Signature of Surveyor

DIAGRAM OF CORNER:

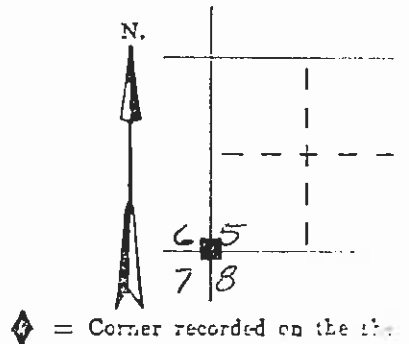

◆ = Corner recorded on the site



3322 S
Registration Number

Office of Clerk and Recorder, County of Lake, State of Montana

This "corner record" was filed for record on the 10th day of June 1980 at 9:25 o'clock A.M.

Microfile No. 255246, in book No. C-1042

ETHEL M. HARDING, CLERK & RECORDER
By: Rosanne Hartoach, Deputy
County Official
Cross Index No. E-5 T. 24N R. 21W