

INSTRUCTIONS

- 1. ... and/or subsequent record used to evaluate the corner position.
- 2. ... description of evidence found, note discrepancies in the record, state method of establishing lost or obliterated corners.
- 3. Description of monument and accessories set to perpetuate the corner position.
- 4. Sketch of corner, show all pertinent data which can best be shown in a sketch example, corner marking, topography ties, position of accessories, etc.
- 5. Certification must be signed and sealed by Registered Land Surveyor in State of Montana.
- 6. Fill in Cross Index & Section Diagram at bottom of sheet.

### CERTIFIED CORNER RECORDATION

Corner SW Cor. of Sec. 20 T. 23N R. 30W P.M.M. SANDERS County

GLO RECORD: None available

FOUND: Found Railroad spike in road intersection

MONUMENTED: Drove a 1/2" x 24" rebar w/plastic yellow cap in exact position of found railroad spike.

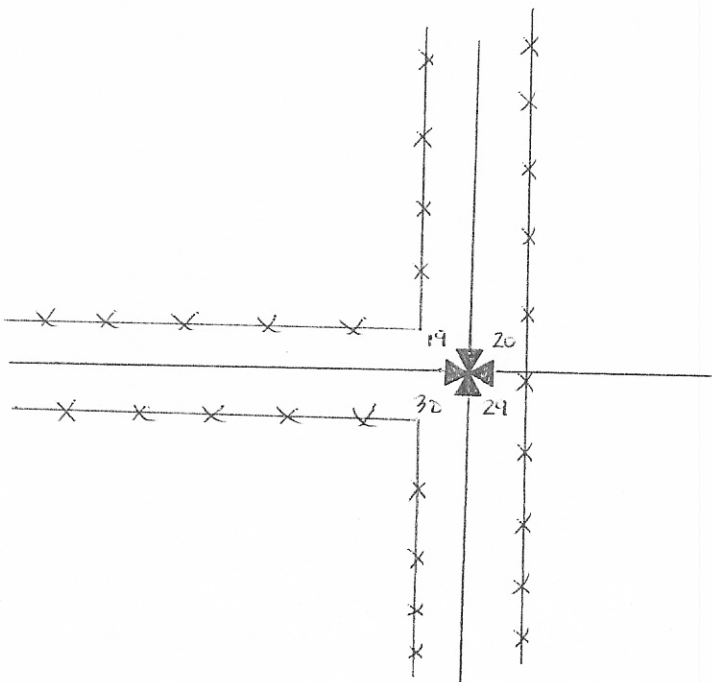

CERTIFICATION

I, \_\_\_\_\_ certify the information shown herein is true and correct.

Signature Ground Agent/Client

H. Gene Warren

I, \_\_\_\_\_ certify that this Corner Record correctly represents work performed by me or under my direction in compliance with the "Corner Recordation Act" (70-22-101, et seq., M.C.A.)

H. Gene Warren  
Signature of Surveyor

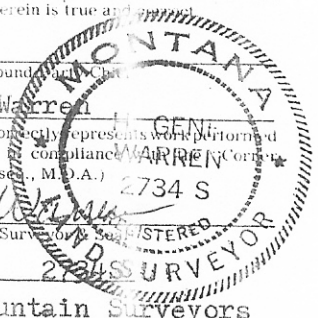

Date: 12/84 Reg. No. 2734 S

Employer: Rocky Mountain Surveyors

2 PAGE 613 SKETCH OF CORNER 178200

Office of Clerk and Recorder, County of Sanders. This "corner record" was filed for record on the May 31 day of 1985 was noted on the cross-index plat and is assigned page No. 613, in book No. 2

Devin Muept by Evelyn Cox  
County Official

Sec. 20

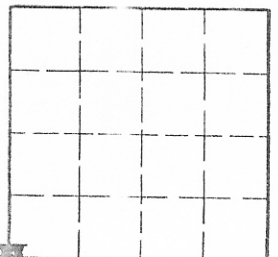

Cross Index No. R5 T. 23N R. 30W P.M.M.

• - corner this sheet