

- INSTRUCTIONS**
1. Original and/or subsequent record used to evaluate the corner position.
 2. Description of evidence found, note discrepancies in the record, state method of establishing lost or obliterated corners.
 3. Description of monument and accessories set to perpetuate the corner position.
 4. Sketch or corner, show all pertinent data which can best be shown in a sketch example, corner marking, topography ties, position of accessories, etc.
 5. Certification must be signed and sealed by Registered Land Surveyor in State of Montana.
 6. Fill in Cross Index & Section Diagram at bottom of sheet.

CERTIFIED CORNER RECORDATION

Corner S. 1/4 S-14 T. 17 R. 27 P.M.M. Mineral Co.

(Record) Stone 12x7x6 ins, 8 ins in ground with 1/4 on North face
 (Found) Stone with 1/4 on north face still well set

(Record) A pine 10" diam bears N66°W 106 lks. dist.
 (Found) Only rotten wood. no stump left.

(Record) A pine 16" diam. bears S74°W 73 lks. dist.
 (Found) Only rotten wood around. No stump left.

We left the stone in place as found and painted it red and marked the following R.M. trees.

8" diam Douglas fir bears N48°W 8.0 ft. dist.
 13" diam Douglas fir bears S21°W 10.5 ft. dist.

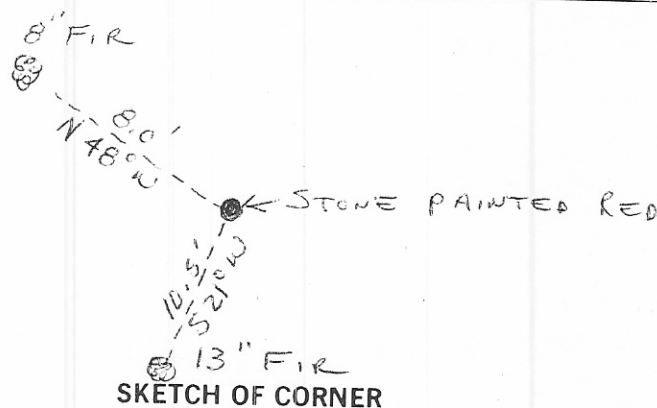

CERTIFICATION

I, _____
 certify the information shown herein is true and correct.

I, _____
 certify that this Corner Record correctly represents the corner as shown on the Recordation Act (70-22-101, et seq., M.D.A.)

Date: _____
 Employer: ROCKY MOUNTAIN SURV

Office of Clerk and Recorder, County of Mineral. This "corner record" was filed for record on the April 4, 1985 at 11:15 A.M. day of 1985, was noted on the cross-index plat and is assigned page No. _____, in book No. _____

Shirley Maxine
 County Official

Sec.

Cross Index No. N-19 T. 17 R. 27 PMM

63591

• - corn