

INSTRUCTIONS

1. Original and/or subsequent record used to evaluate the corner position.
2. Description of evidence found, note discrepancies in the record, state method of establishing lost or obliterated corners.
3. Description of monument and accessories set to perpetuate the corner position.
4. Sketch of corner, show all pertinent data which can best be shown in a sketch example, corner marking, topography (lie, position of accessories, etc.
5. Certification must be signed and sealed by Land Surveyor registered in the State of Montana.
6. Fill in Cross Index & Section Diagram at bottom of sheet.

089695

CERTIFIED CORNER RECORDATION

Corner 4 17 T. 17N. R. 26W. P.M.M. MINERAL County

RECORD: 1900. Set a quartzited stone 16x7x6 ins. 11 ins. in the ground for 1-4 Sec. Cor., marked 1-4 on N. face; from which

A fir 9 ins. diam. bears S.60°E. 104 lks.(68.64 ft.) dist. marked 1-4S17BT.

No other tree within limits; raise a mound of stone 2 ft. base, 1½ ft. high, N. of cor. Pits impracticable.

RECORD: 1904, GLO Resurvey made this corner common to sec. 17 only.

FOUND: 1997. A stone 6x7x16 ins. lying on the ground (downhill from the corner position) with "¼" on one face. SEE PERPETUATION BELOW.

A 39 inch dia. D.fir bears S.60°E., 68.64 ft. scribing grown over.

A scattered mound of stones downhill.

PERPETUATION: Using record bearing and distance from the BT set a std. USDA alum. pipe 2½ ins. dia. by 30 ins. long with a 3½ inch dia. alum. cap 8 ins. above the ground marked:

Buried the stone alongside the pipe.

No trees within limits for new BT's.

Placed BT and LSM signs.

Painted the blazes red.

Decl. 18°E.

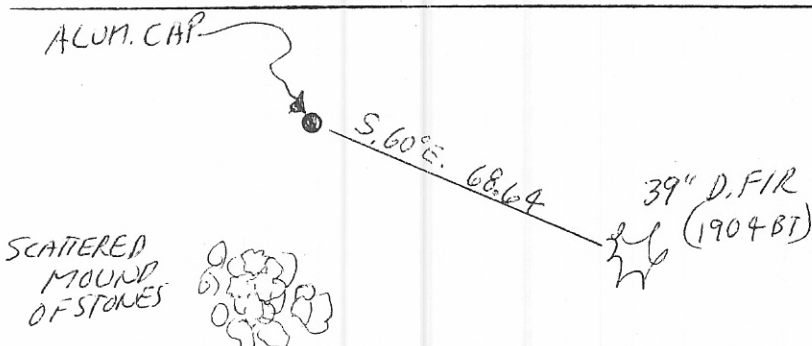
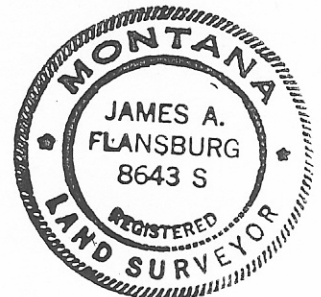
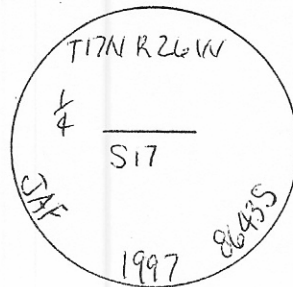

SKETCH OF CORNER

CERTIFICATION

I, EDDO M. FLURI
 certify the information shown herein is true and correct.
Eddo M. Fluri
 Signature Ground Party Chief

I, JAMES A. FLANSBURG
 certify that this Corner Record correctly represents work performed by me or under my direction in compliance with the "Corner Recordation Act" (70-22-101, et seq., M.C.A.)
James A. Flansburg
 Signature of Surveyor & Seal

Date: 10-2-97 Reg. No. 8643 S
 Employer: U.S.F.S.

Office of Clerk and Recorder, County of MINERAL. This "corner record" was filed for record on FEBRUARY 1, 2001 @ 9:10 A.M. was noted on the cross-index plat and is assigned page No. _____, in book No. _____, 089695 Katherine Jasper by D Henderson County Official

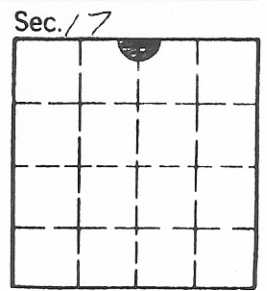

• - corner this sheet

Cross Index No. J-7 T. 17N. R. 26W. P.M.M.