

INSTRUCTIONS

1. Original and/or subsequent records used to evaluate the corner position
2. Description of evidence found, note discrepancies in the record, state method of establishing lost or obliterated corners.
3. Description of monument and accessories set to perpetuate the corner position
4. Sketch of corner, show all pertinent data which can best be shown in a sketch example, corner marking, topography ties, position of accessories, etc.
5. Certification must be signed and sealed by Land Surveyor registered in the State of Montana.
6. Fill in Cross Index & Section Diagram at bottom of sheet.

61- 401825

CERTIFIED CORNER RECORDATION

Corner: 1/4 Section Corner 26 & 35 T. 17N R. 20W P.M.M. Lake County

ORIGINAL RECORD: (1904 G.L.O.) Set a sandstone, 18x6x6 ins., 12 ins. in the ground marked 1/4 on N. face; and raise a mound of stone 2 ft. base, 1 1/2 ft. high, N. of corner.

PREVIOUS RECORD: See corner recordation #231475. Found a 1 1/2" solid round pin marked "1/4 cor."

EVIDENCE FOUND: Found a 1 1/2" solid round shaft with "X" on top.

PERPETUATION: Set a 3 1/4" MDT aluminum cap on a 30" aluminum pipe in the position of the pin. The cap is marked as shown in the sketch. From which;
 A power pole bears N68°W, 2.8' distant; with a MARLS tag.
 A fence corner post bears N2°E, 21.4' distant; with a MARLS tag.

Gravel Road

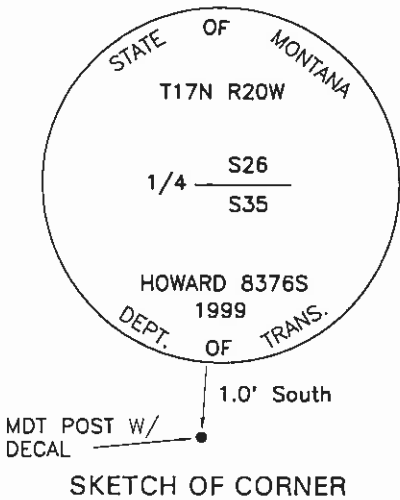

Irrigation Ditch

CERTIFICATION

I, Rod Cone
 certify the information shown herein is true and correct.

Rod Cone
 Signature Ground Party Chief

I, Glenn R. Howard
 certify that this Corner Record correctly represents work performed by me or under my direction in compliance with the "Corner Recordation Act" (70-22-101, et seq., M.C.A.)

Glenn R. Howard *
 Signature of Surveyor & Seal 8376 S

Date: 8-9-99 Reg. No. 8376 S

Employer: DJ&A, P.C.

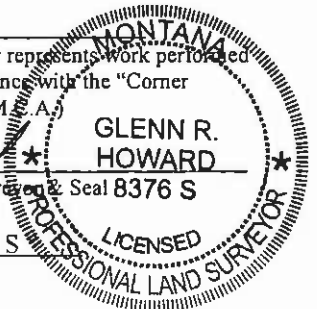

Office of Clerk and Recorder, County of Lake. This "corner

record" was filed for record on AUG 11 1999 10:54 AM

as noted on the cross index plat and is assigned page No. 401825, in

Book No. C-2251 RUTH L. HODGES Judy Muniz Dep
 County Official

Sec. 35

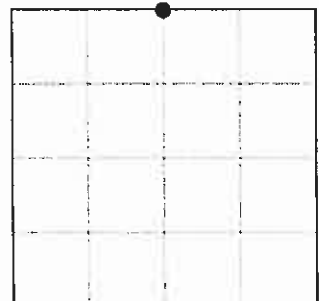

• - corner this sheet

Cross Index No. V-19 T. 17N R. 20W PMM

Adopted July 1, 1981, Montana Board of Professional Engineers & Land Surveyors

N/C