

# CERTIFIED CORNER RECORDATION

Corner W 1/4 COR. S.23 T. 8N. R. 15E. P.M.M. Wheatland County

**ORIGINAL RECORD:** 1874 GLO NOTES: SET SANDSTONE 18 X 15 X 2 INS. 12 INS. IN THE GROUND FOR 1/4 SEC. COR. MARKED 1/4 ON W. FACE.

**SUBSEQUENT RECORD:** CERTIFICATE OF SURVEY NO#86199 RESET THE 1/4 CORNER BETWEEN SEC. 22 & 23. DONE BY RAYMOND ESP ON NOVEMBER 9TH, 1983. C/S NO. 93074 SHOWS A TIE TO THIS CORNER, FROM FOUND ESP PINS, THE TWO TIES DO NOT MATCH.

**EVIDENCE FOUND:** FOUND A ESP REB. & CAP AT THE N.E. COR TRACT C OF C/S 86199. MEASURED DIST. TO ESP 1/4 COR. IS 4.8' SHORT OF RECORD.

**RE-ESTABLISHMENT:** FROM FOUND ORIGINAL MONUMENTS IN LIBERTY PARK SUBDIVISION, THE RE-ESTABLISHED 1/4 COR. POSITION FALLS N.49°33'W., 2.35' FROM THE ESP POSITION. AT THIS POSITION, FOUND A 1" SQUARE IRON PIN. ACCEPTED THE IRON PIN AS THE BEST EVIDENCE OF THE ORIGINAL CORNER.

**PERPETUATION:** IN PLACE OF 1" SQUARE IRON PIN, SET A STANDARD MDT 2"x30" ALUMINUM MONUMENT WITH 3.25" CAP ABOVE GROUND. SET REFERENCE POST 1.0' SOUTH. SET 5/8" REBAR WITH 2" MDT AC REFERENCE MONUMENTS FLUSH WITH THE GROUND AS SHOWN BELOW.

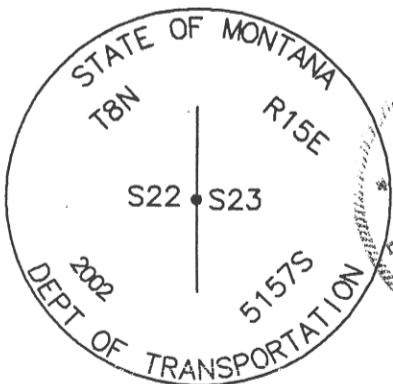
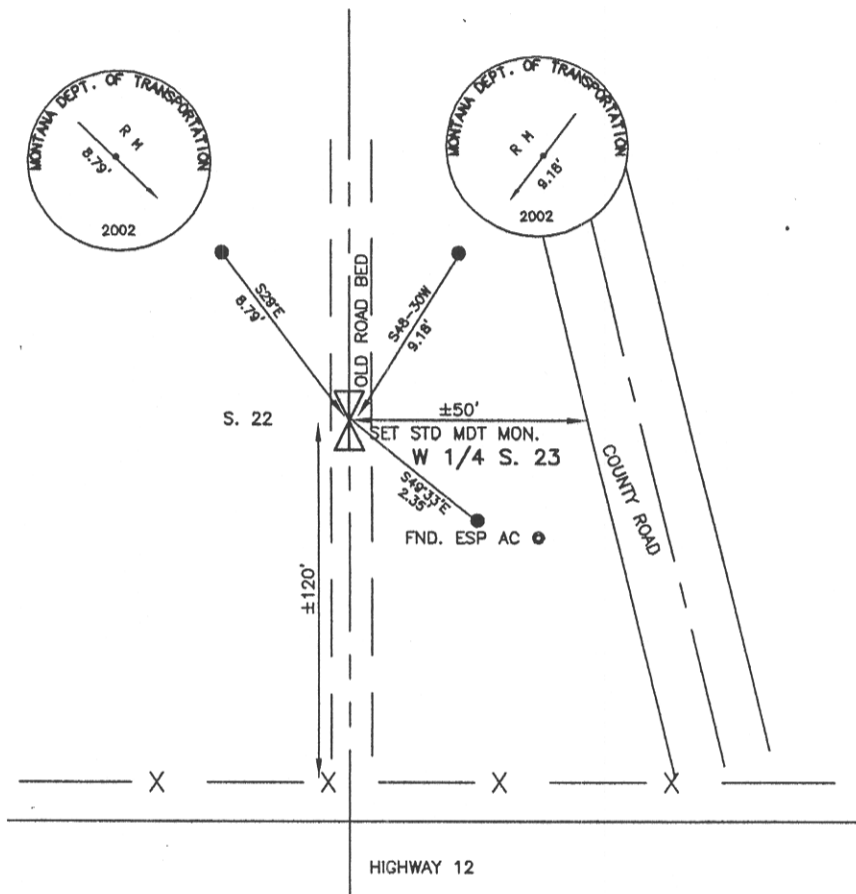

SKETCH OF CORNER

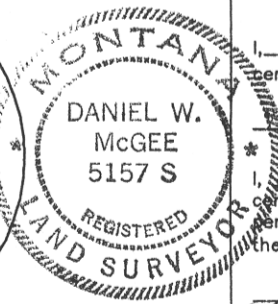

CERTIFICATION	
I, <u>PHIL KOTERBA</u>	
certify the information shown herein is true and correct	
_____ Signature Ground Party Chief	
I, <u>Daniel W. McGee</u>	
certify that this Corner Record correctly represents work performed by me or under my direction in compliance with the "Corner Recordation Act" (70-22-101, et seq., M.C.A.)	
_____ Signature of Surveyor & Seal	
Date: <u>12/20/02</u>	Reg. No. <u>5157S</u>
Employer: <u>HARP Engineering</u>	

Office of Clerk and Recorder, County of Wheatland. This "corner record" was filed for record on 12-23-2002 was noted on the cross-index plat and is assigned page No. 178, in document book No. 101480 tsmart

County Official

Cross Index No. P 17 T. 8N. R. 15E. PMM

Sec. 23

● - Corner this sheet