

47368

INSTRUCTIONS

1. Original and/or subsequent record used to evaluate the corner position.
2. Description of evidence found, note discrepancies in the record, state method of establishing lost or obliterated corners.
3. Description of monument and accessories set to perpetuate the corner position.
4. Sketch of corner, show all pertinent data which can best be shown in a sketch example, corner marking, topography ties, position of accessories, etc.
5. Certification must be signed and sealed by Land Surveyor registered in the State of Montana.
6. Fill in Cross Index & Section Diagram at bottom of sheet.

CERTIFIED CORNER RECORDATION

Corner SOUTH QUARTER CORNER SECTION 13 T. 7N R. 59E P.M.M. FALLON County

SINGLE PROPORTIONED ALONG THE SOUTH SECTION LINE OF SECTION 13 AND SET A 5/8" x 24" REBAR WITH 2" ALUMINUM CAP.

REFERENCED MONUMENT AS SHOWN ON THE SKETCH BELOW AND ON THE REVERSE SIDE OF THIS FORM.

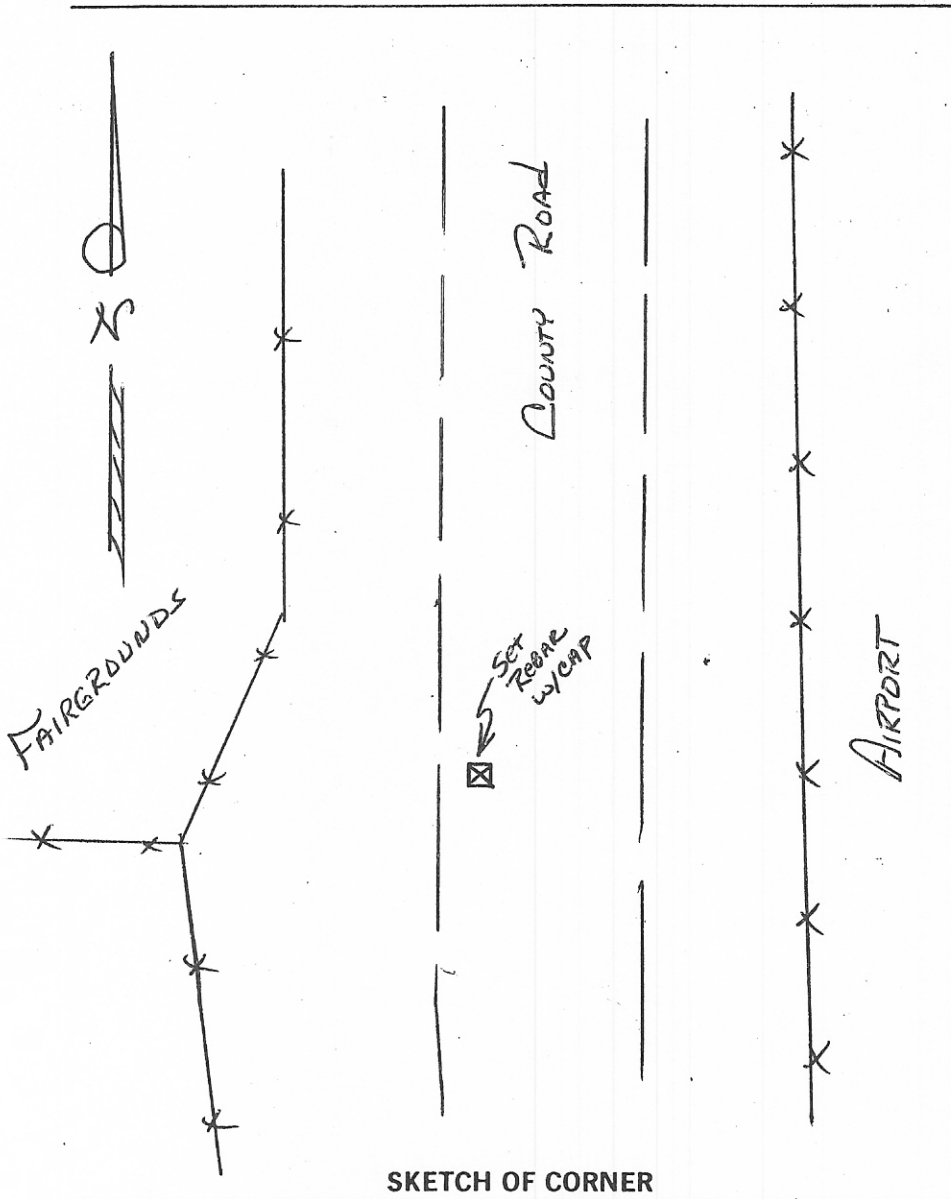

SKETCH OF CORNER



CERTIFICATION  
 I, Charles M. Madler,  
 certify the information shown hereon is true and correct.  
 Signature of Charles M. Madler  
 Registered Professional Surveyor  
 7327 S  
 I, Charles M. Madler,  
 certify that this Corner Record correctly represents work performed  
 by me or under my direction in compliance with the "Corner  
 Recordation Act" (70-22-101, et seq., M.S.A.)  
 Signature of Surveyor & Seal  
 Date: 9-25-85 Reg. No. 7327S  
 Employer: Fallon County

Office of Clerk and Recorder, County of Fallon This "corner  
 record" was filed for record on November 5, 1985 at 8:10 A.M.

was noted on the cross-index plat and is assigned page No. 207-208, in

book No. 1  
 Fee: N/C

Myra Lee Dietz  
 County Official

Sec. 13

• - corner this sheet

BOOK 1 PAGE 207

Cross Index No. N-23 T. 7N R. 59E P.M.M.