

CERTIFIED CORNER RECORDATION

Corner SWCOR SEC 16 T. 7 N., R. 9 W., P.M.M. POWELL County

Original: POST IN MOUND OF EARTH WITH PITS

Subsequent: REBAR & ALUMINUM CAP SET BY RAY G. MASTERS ON 10-12-77 PER COUNTY CORNER RECORDS

Evidence: FOUND REBAR (BENT) AT POSITION (VERY NEARLY) AS STATED BY RE. MASTERS IN HIS CORNER RECORD.

Perpetuation: SET MARLS TAGS AS INDICATED ON SKETCH.

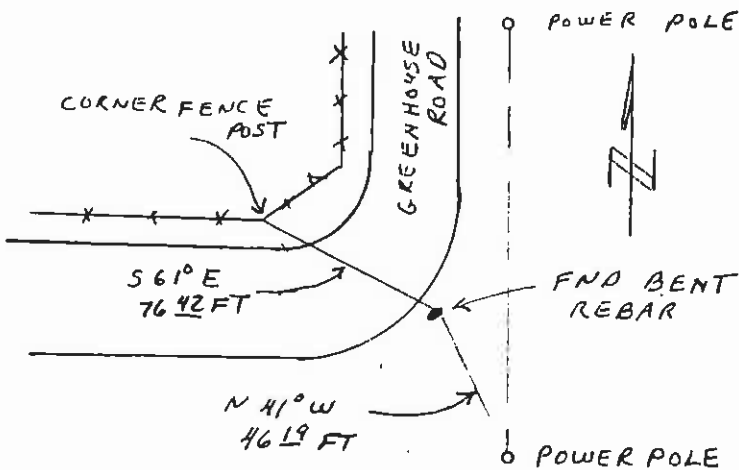

See Certificate of Survey Number _____ for further information

FOUND BENT REBAR

Sketch of Corner

145213

CERTIFICATION

I, Morris A. Zahn
certify the information shown herein is true and correct.

Morris A. Zahn
Signature of Ground Party Chief

I, Morris A. Zahn
certify that this Corner Record correctly represents work performed by me or under my direction in compliance with the "Corner Recordation Act" (70-22-101, M.G.A.)

Morris A. Zahn
Signature of Surveyor & Seal

Date: 5/11/98 Reg. No. 11798

Employer: ARROWHEAD SURVEYING

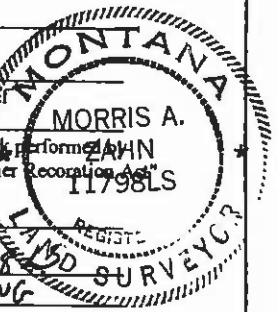

Section 16

Office of Clerk and Recorder, County of Powell
This "corner record" was filed for record on May 19th, 1998 @ 2:00 P.M.
was noted on the cross index plat and is assigned page No. _____
in book No. _____

N/C

Paul M. Dyer
County Official

Cross Index No. N-9

T. 7 N., R. 9 W., PMM

THIS CORNER