

INSTRUCTIONS

1. Original and/or subsequent record used to evaluate the corner position.
2. Description of evidence found, note discrepancies in the record, state method of establishing lost or obliterated corners.
3. Description of monument and accessories set to perpetuate the corner position.
4. Sketch of corner, show all pertinent data which can best be shown in a sketch example, corner marking, topography ties, position of accessories, etc.
5. Certification must be signed and sealed by Land Surveyor registered in the State of Montana.
6. Fill in Cross Index & Section Diagram at bottom of sheet.

CERTIFIED CORNER RECORDATION

Corner 1/4 COR 20 27 T. 6 N R. 26 E P.M.M. MUSSELHELL County

RECORDATION S 1/4 S. 20 T. 6 N R. 26 E

RECORD: 1904 SUBDIVISION BY FL. CUMMING.
 SET SANDSTONE 30"x24"x3" MKD 1/4 ON N. FACE
 15" PINE BEARS S 40 1/4° E, 2.03 CH., MKD 1/4 S29 BT,
 18" PINE BEARS N 80 1/2° W, 3.04 CH., MKD 1/4 S20 BT.

FOUND: NO EVIDENCE OF STONE OR B.T'S. THERE
 ARE A FEW OLD STUMPS IN AREA, BUT NONE
 WITH VERY GOOD PATTERN. RE ESTABLISH
 CORNER BY SINGLE PROPORTION MEASURE
 BETWEEN SW COR SEC. 20 AND SE COR SEC. 20
 T. 6 N., R. 26 E.

PERPETUATION: AT CORNER POINT SET A
 2 1/2" x 30" IRON POST 2 1/2" IN THE GROUND
 WITH A 3 1/4" BRASS CAP MKD:
 MM./CSSA
 T. 6 N. R. 26 E
 1/4 S20
 S29
 1992

CORNER FITS RECORD. TOPO CALL (58 FT EAST)

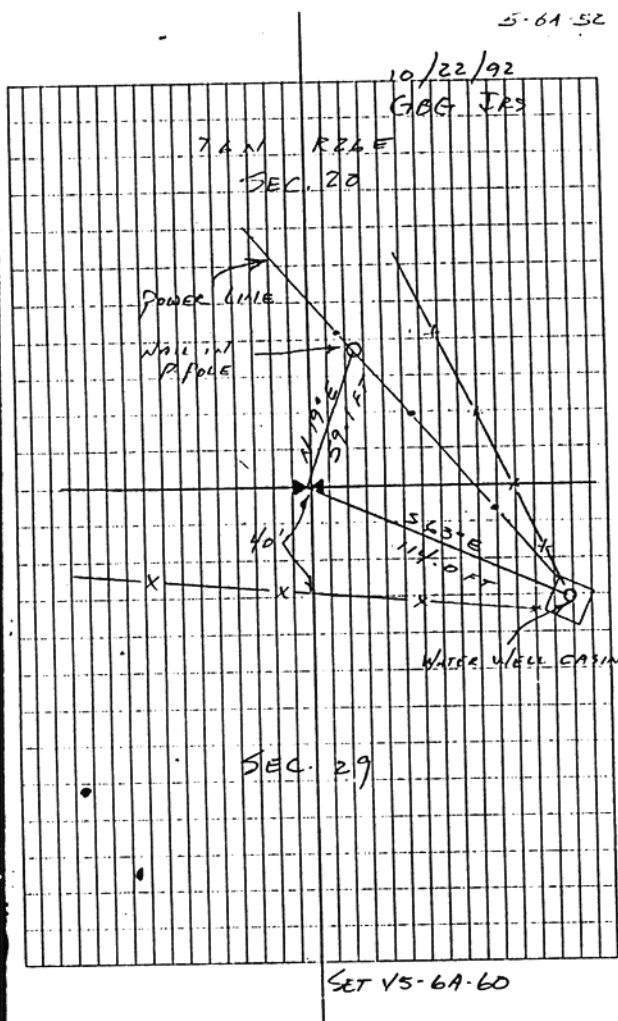

CERTIFICATION

I, GUNNAR GETCHELL
 certify the information shown hereon is true and correct.

Gunnar B. Getchell
 Signature of Ground Party Chief

GUNNAR B. GETCHELL
 certify that this Corner Record correctly represents work performed
 by me or under my direction in compliance with the "Corner
 Recordation Act" (70-22-101, et seq., M.C.A.)

Gunnar B. Getchell
 Signature of Surveyor & Seal

Date: 1/93 Reg. No. 9758 LS

Employer: MORRISON-MAIERLE/CSSA



SKETCH OF CORNER

Office of Clerk and Recorder, County of Musselshell. This "corner
 record" was filed for record on January 6, 1993 9:08 AM

was noted on the cross-index plat and is assigned page No. _____, in
 book No. _____ Jane E Mang
Norma M Weigmann
 County Official

Sec. 20

