

INSTRUCTIONS

1. Original . . . r subsequent record used to evaluate the corner position.
2. Description of evidence found, note discrepancies in the record, state method of establishing lost or obliterated corners.
3. Description of monument and accessories set to perpetuate the corner position.
4. Sketch of corner, show all pertinent data which can best be shown in a sketch example, corner marking, topography ties, position of accessories, etc.
5. Certification must be signed and sealed by Land Surveyor registered in the State of Montana.
6. Fill in Cross Index & Section Diagram at bottom of sheet.

CERTIFIED CORNER RECORDATION

CORNER W1/4 SECTION 17 T 5 N R 13 W PMM ANACONDA-DEER LODGE COUNTY

RECORD: BLM DEPENDENT RESURVEY, JULY 11 TO SEPT 25, 1967

SET AN IRON POST, 30in LONG, 2 1/2 in DIAM., 24in IN THE GROUND, WITH BRASS CAP MKD.

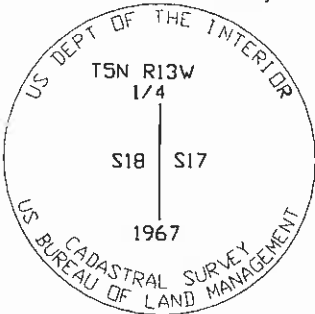

FROM WHICH:

A FIR 10 in DIA BEARS N 5 3/4 ° E, 50 LKS DIST, MKD 1/4S17 BT
 A PINE 12 in DIA BEARS S 68 3/4 ° W, 49 LKS DIST, MKD 1/4S18 BT
 BURIED FOUND IRON PIPE ALONGSIDE

FOUND: 3 1/4 IN BRASSCAP, 5 IN ABOVE GRND WITH RING OF STONE MARKED AS SHOWN
 FOUND IRON PIPE ALONGSIDE

12" FIR, BLAZE GROWN OVER, BEARS S 68 3/4 ° W, 49 LKS (32.3 FT) DISTANT
 10" FIR AT N 5 3/4 ° E, 50 LKS (33 FT) DESTROYED

SET: NOTHING

NOTE: ALL DISTANCES NOTED FOR BEARING TREES ARE HORIZONTAL DISTANCES FROM THE CENTER OF THE TREE TO THE MONUMENT

SKETCH OF CORNER

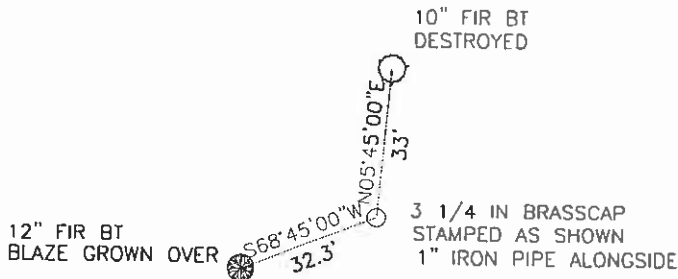

CERTIFICATION

I, Greg LaZerte
 certify the information shown herein is correct



Signature Ground Party Chief

I, Greg A. LaZerte, LS
 certify that this Corner Record correctly represents work performed by me or under my direction in compliance with the "Corner Recordation Act" (10-22-101, et seq., M.C.A.)

Greg A. LaZerte
 Signature of Surveyor & Seal

Date: 10/17/2002 Reg. No. 14725LS

Employer: WGM Group, Inc.

Office of Clerk and Recorder, County of DEER LODGE . This "corner record" was filed for record on the OCTOBER 21 day of 2002

was noted on the cross-index plat and assigned Page No. 555 in Book No. 2 Barbara J. Vaughn, DEPUTY County Official

Cross Index No. L-5 T 5 N R 13 W PMM

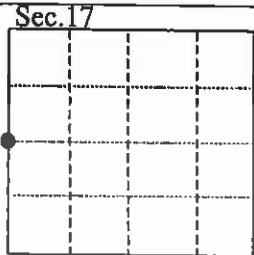

• - Corner this sheet