

CERTIFIED LAND CORNER RECORDATION

DESCRIPTION OF CORNER EVIDENCE FOUND, AND ORIGINAL RECORD (IF KNOWN)

Original Record: Set a sandstone, 16x10x4 ins., 11 ins. in the ground, for closing cor. of secs. 1 and 2, marked CC, CMR, on S., with 1 groove on E., and 5 grooves on W. faces, dig pits, 24x18x12 ins. crosswise on each line, E. and W. 3 ft. and S. of stone, 7 ft. dist., and raise a mound of earth, 4 ft. base, 2 ft. high S. of cor.

Found: Sandstone, 11x8x4 ins., 16 ins., Below ground level, oriented east-west, on County Road No. 157.

DESCRIPTION OF MONUMENT AND ACCESSORIES ESTABLISHED TO PERPETUATE THE ORIGINAL LOCATION OF THIS CORNER: F.B. 6-1-64

Date of work: Sept., 1982

Set an aluminum post 30 ins. long, 2 1/2 ins. diam., 42 ins. in the ground with magnet imbedded aluminum cap marked:

T.1S. R.33E.

Placed original sandstone alongside post. Set tract corner, S00°10'07"E., 30.00 ft.; Set aluminum post 30 ins. long 2 1/2 ins. diam., 24 ins. in ground in concrete on county road R/W line. W/Alum. cap MKD:

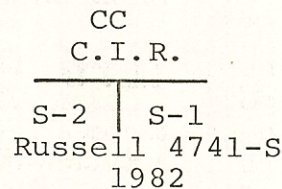
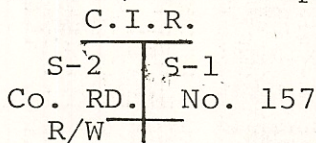

SKETCH, WITH COURSE AND DISTANCE TO ADJACENT CORNERS IF DETERMINED IN THIS SURVEY. (MAY SKETCH OR PASTE REPRODUCTION ON REVERSE SIDE.)

See Reverse

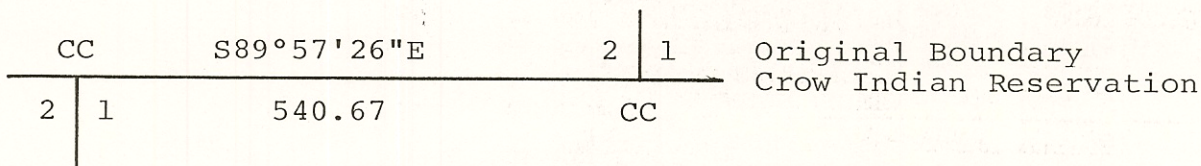

Surveyor's Seal

I, Gerald P. Russell, certify that the information shown herein is true and correct.

Signature of Ground Party Chief

I, Gerald P. Russell, certify that I have carefully performed or reviewed the work done on the diagrammed corner as reported on this recordation form and approve the same.

Signature of Surveyor (handwritten signature)

DIAGRAM OF CORNER:

N. T.1S. R.33E.

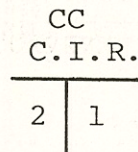

= Corner recorded on the sheet

4741-S Registration Number

276610

Office of Clerk and Recorder, County of Big Horn, this "corner record" was filed for record on the DEC 1 1982 day of 9:20 AM, was noted on the cross-index plat and is signed page No. 220, in book No. 2

County Official (handwritten signature)

THE NW1/4NW1/4, SECTION 12, T. 1 S.,  
 BIG HORN COUNTY, MON

FOR: MONTANA POWER CO  
 BY: DELTA SURVEYS  
 BILLINGS, MONTANA  
 SEPTEMBER, 1982

