

CERTIFIED CORNER RECORDATION

CORNER NW COR SEC 2 T. 2 S R. 33 E P.M.M. BIG HORN COUNTY

ORIGINAL RECORD
GLO 1883

Set a post 4 ft. long 5 ins. sq. with marked stone 12 ins. in the ground for cor. to Sec. 2, 3, 34 and 35 marked T1S S35 on N.E., T2S S2 on S.E., R33E S3 on S.W. and S34 on N.W. faces, with 2 notches on E. and 4 on W. edges, dug pits 18x18x12 ins. in each sec. 5 1/2 ft. dist. and raised a mound of earth 2 ft. high 4 1/2 ft. base around post. John T. Blake U.S. Surveyor.

BLM 1950

The cor. of secs. 2, 3, 34, and 35, at the intersection of the gravel road with an oiled highway, between Hardin and St. Xavier, at the point determined at the right of way fences, accepted as the best available evidence of the corner position. At the corner point, drive an automobile valve stem, 1 1/2 ins. diam., 6 in. stem, flush with the surface of the pavement from which, an iron post, 28 ins. long, 2 1/2 ins. diam., set 24 ins. in the ground, for reference monument, bears S.55°W., 54.0 ft. dist., with a brass cap mkd. S3 RM 54.0 FT 1950 and an arrow pointing to the true cor. An iron post, 28 ins. long, 2 1/2 ins. diam., set 24 ins. in the ground, for reference monument, bears N.68°45'W., 73.1 ft. dist., with a brass cap mkd. S34 RM 73.1 FT 1950 and an arrow pointing to the true cor. David K. Scott Cadastral Engineers

BLM 1990

The cor. of secs. 2, 3, 34, and 35, determined at the intersection of Montana State Highway No. 313, extending N. and S., and a county road extending E. and W., and is accepted as the best available evidence of the position of the original cor. At the point, set a 16 penny nail flush with the surface of the hard top road. from which, a stainless steel post, 30 ins. long, 2 1/2 ins. diam., set 24 ins. in the ground, for a reference monument, bears N.34°E., 42.0 ft. dist., with brass cap mkd. RM T1S R33E S35 42.0 FT 1989, and an arrow pointing to the cor. A stainless steel post, ins. long, 2 1/2 ins. diam., set 24 ins. in the ground, for a reference monument, bears S.33°15'W., 34.0 ft. dist., with brass cap mkd. RM T2S R33E S3 34.0 FT 1989, and an arrow pointing to the cor. Harry M. Dietz Cadastral Surveyor

FOUND - MDT 2007
SET - MDT 2007

PK Nail for sec. cor. and one BLM reference monument, as shown below
Replaced PK Nail with an MDT aluminum cap on rebar. Set a reference monument 1' East of a power pole

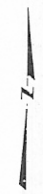

NTS

Ground distances based on GPS RTK
Basis of Bearings - NAD83 MT2500
Convergence angle - +1°22'25"

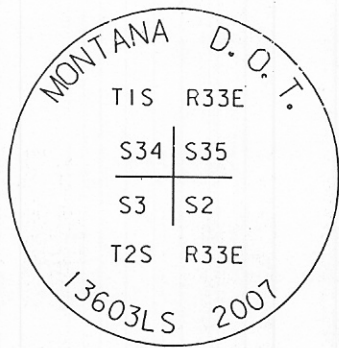
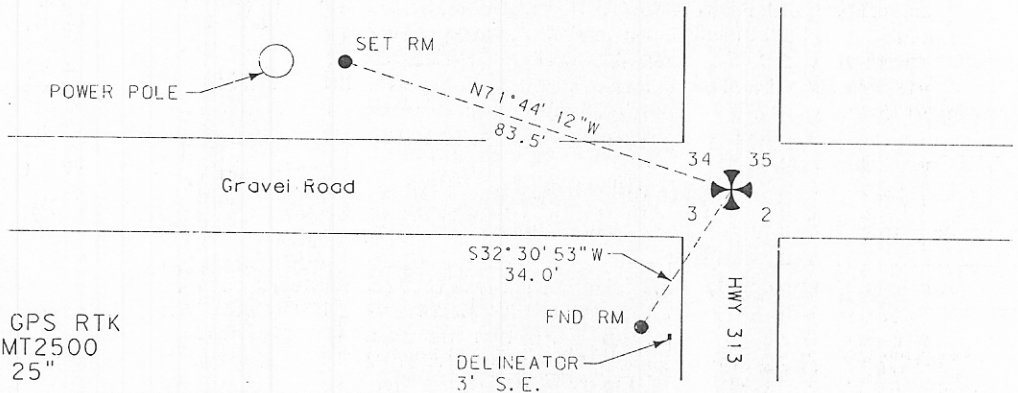

CERTIFICATION

I, _____
CERTIFY THE INFORMATION SHOWN HEREIN IS TRUE AND CORRECT.

MONTANA
SIGNATURE GROUND PARTY CHIEF
David M. David
I, David M. David
CERTIFY THAT THIS CORNER RECORD CORRECTLY REPRESENTS WORK PERFORMED BY ME OR UNDER MY DIRECTION IN COMPLIANCE WITH THE CORNER RECORDATION ACT (78-28-301 ET SEQ., M.C.A.)

MONTANA
LICENSED SURVEYOR
SIGNATURE OF SURVEYOR
David M. David
DATE: 11/6/2007 REG. NO. 13603LS
EMPLOYER: MONTANA DEPARTMENT OF TRANSPORTATION

SKETCH OF CORNER

OFFICE OF CLERK AND RECORDER, COUNTY OF _____ THIS CORNER

RECORD WAS FILED FOR RECORD ON NOV 07 2007

WAS NOTED ON THE CROSS-INDEX PLAT AND IS ASSIGNED PAGE NO. 378, IN

BOOK NO. 5
337982

Lyndy B. McFarland
COUNTY OFFICIAL

CROSS INDEX NO. A-17 T. 2S R. 33E PMM

ADOPTED JULY 1, 1981, MONTANA BOARD OF PROFESSIONAL ENGINEERS & LAND SURVEYORS

SEC. 2

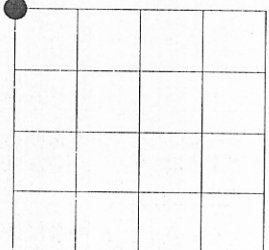

• CORNER THIS SHEET