

**CERTIFIED LAND CORNER RECORDATION**

**DESCRIPTION OF CORNER EVIDENCE FOUND, AND ORIGINAL RECORD (IF KNOWN)**

Corner evidence found:

U. S. G. L. O. brass cap, marked appropriately as the corner to sections 5, 6, 7, and 8, and as being set in 1947, with a mound of rocks raised to the west.

**DESCRIPTION OF MONUMENT AND ACCESSORIES ESTABLISHED TO PERPETUATE THE ORIGINAL LOCATION OF THIS CORNER:**

Date of work: July 1983

**SKETCH, WITH COURSE AND DISTANCE TO ADJACENT CORNERS IF DETERMINED IN THIS SURVEY. (MAY SKETCH OR PASTE REPRODUCTION ON REVERSE SIDE.)**

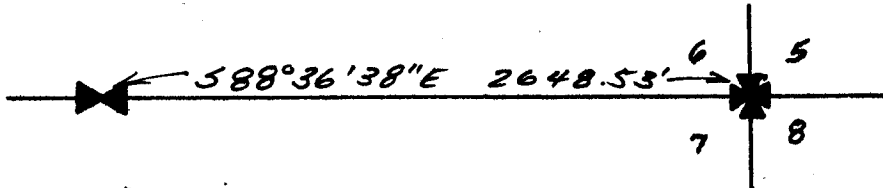

Surveyor's Seal

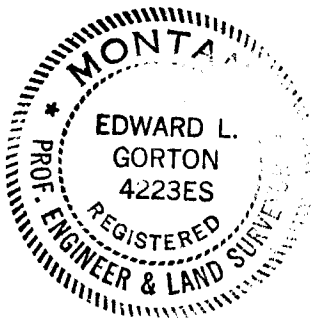

I, \_\_\_\_\_  
certify that the information shown herein is true and correct.

Signature of Ground Party Chief

Edward L. Gorton

I, \_\_\_\_\_  
certify that I have carefully performed or reviewed the work done on the diagrammed corner as reported on this recordation form and approve the same.

*Edward L. Gorton*  
Signature of Surveyor

4223 ES  
Registration Number

**DIAGRAM OF CORNER:**

N. Sec. CORNER

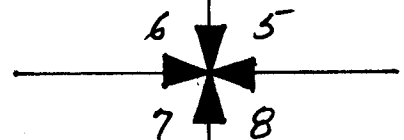

T35, R10E, MPM  
= Corner recorded on the sheet

173045

Office of Clerk and Recorder, County of Park

This "corner record" was filed for record on the 21st day of February 1984, at 10:04 AM, was noted on the cross-index plat and is

assigned page No. 24, in book No. one

No Fee

County Official by Margaret Monical Deputy

Cross Index No. E-5 T. 35 R. 10 E Mot.